

Keep System 6" (152 mm) min. above grade

Rollershield Drainage CIFS™

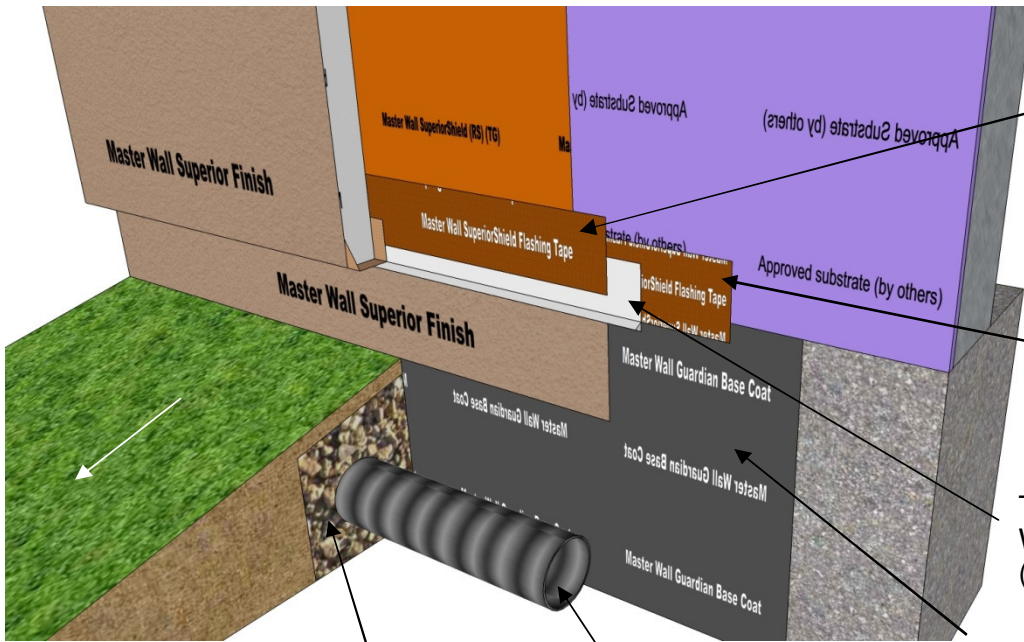
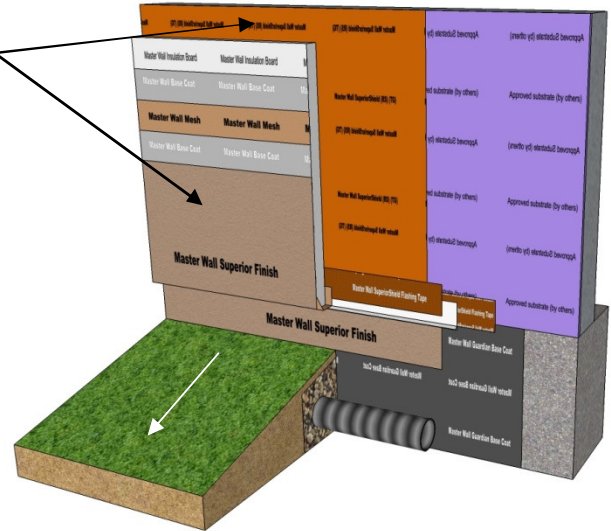

Rollershield Flashing Tape (Flash onto Termination Accessory)

Rollershield Flashing Tape (Air Seal)

Termination Accessory - Stucco Weep Screenshot shown, place 1" (25 mm) min. onto foundation

Drainable Fill

Drain

Guardian Base Coat

- 1/16" (1.58 mm) as standard base coat
- 1/8" (3.18 mm) as waterproofing

RDCIFS SD 015 TRANSITION AT GRADE WITH GUARDIAN

<https://3dwarehouse.sketchup.com/model/ecaa86dc-c4c0-48bb-a6c2-ede3e886cb92/Master-Wall-Inc-Rollershield-Drainage-CIFS%E2%84%A2-Special-Detail-015-Guardian-Transition>

These drawings relay the conceptual conditions of Master Wall® Systems and are not the construction drawings. Ultimately the design and detailing of an entire wall system is the responsibility of a professional. These details will guide the design professional in the use of Master Wall® Products. Master Wall disclaims design, warranty or construction intent or responsibility. **Bold = Master Wall® Product.** ©2017 Master Wall Inc.®