



We finish strong.

System Detail

MIAMI-DADE COUNTY
APPROVED

Dade NOA No. 19-1105.06
Expires 6/16/2021

3-5/8" x 18 ga metal framing @ 16" o.c.

1/2" Sheathing fastened with #6 x 1-1/4" bugle head screws @ 6" o.c.

Master Wall Base Coat & Ultra Mesh

Rollershield (optional)

Master Wall Adhesive

Aggre-flex Insulation

Master Wall Base Coat & Standard Mesh

20 ga x 2" strapping @ midsection on open framing

Superior Finish

Design Pressure +/- 75psf
Large & Small Missile Impact Rated

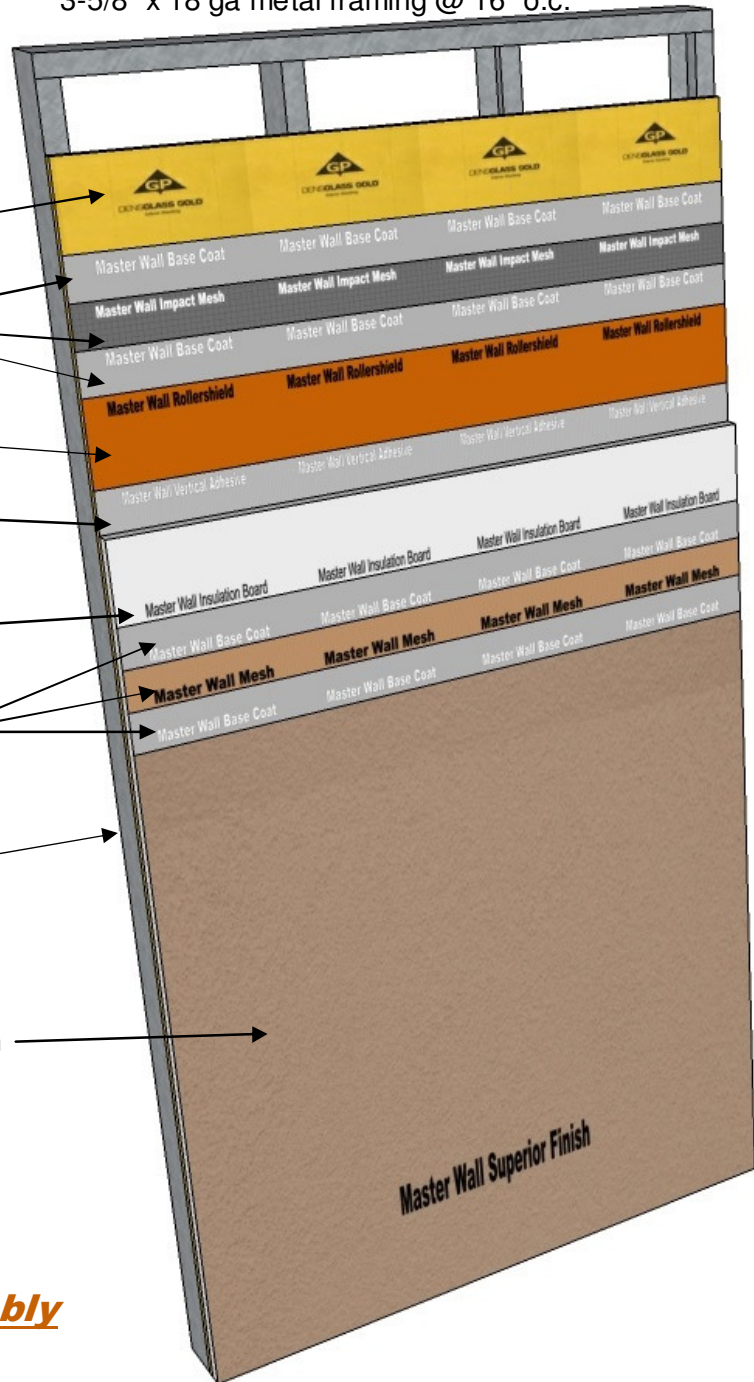

H75F5 Hurricane Assembly

These drawings relay the conceptual conditions of Master Wall[®] Systems and are not the construction drawings. Ultimately the design and detailing of an entire wall system is the responsibility of a professional. These details will guide the design professional in the use of Master Wall[®] Products. Master Wall disclaims design, warranty or construction intent or responsibility. **Bold = Master Wall[®] Product.**

©2019 Master Wall Inc.[®]