

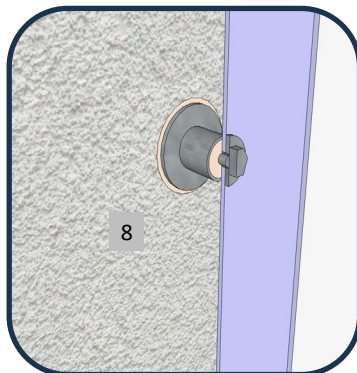

Master Wall Inc.
Building a Culture of Excellence

**ROLLERSHIELD DRAINAGE
CIFS® TYPE MW**

SYSTEM DETAIL

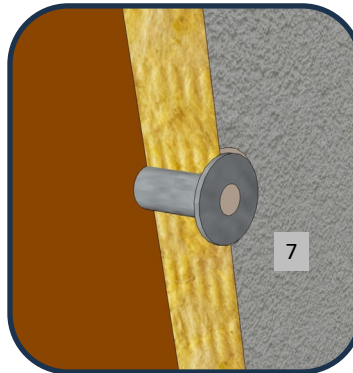
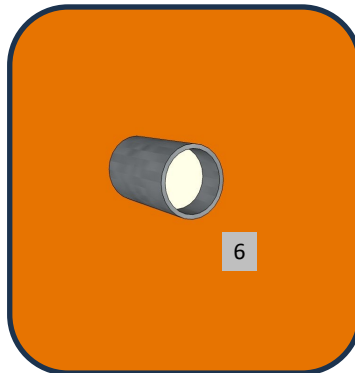
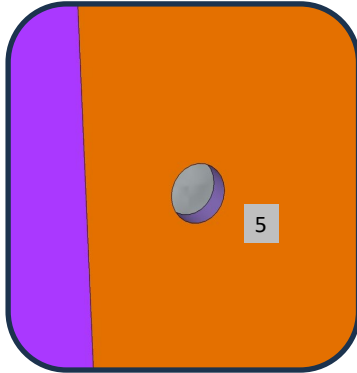

1. FRAMING, SIGNAGE SUPPORT AND APPROVED SUBSTRATE
2. ROLLERSHIELD AIR/WATER BARRIER
3. ROLLERSHIELD DRAINAGE CIFS® TYPE MW
4. SIGNAGE
5. PRE-DRILL HOLE THE SIZE OF THE STRUCTURAL SLEEVE THROUGH CIFS® (NOT SHOWN) AND SUBSTRATE TO STRUCTURAL SUPPORT
6. INSERT STRUCTURAL SLEEVE SIZED FOR SUBSTRATE, INSULATION AND LAMINA THICKNESS AND FILL WITH SEALANT
7. SET OVERSIZE WASHER IN SEALANT
8. INSTALL A STRUCTURAL SPACER TO VENTILATE BEHIND THE SIGNAGE (APPROXIMATELY 1" OR 25 MM) AND FASTEN SIGNAGE TO THE STRUCTURAL SUPPORT

NOTE: CIFS® IS NON-STRUCTURAL. SUPPORT LOADS MUST PASS THROUGH TO PROPER STRUCTURAL SUPPORT

RDCIFSMW-24 TYPICAL SIGNAGE ATTACHMENT

M Master Wall Inc.
Building a Culture of Excellence

These drawings relay the conceptual conditions of Master Wall® Systems and are not the construction drawings. Ultimately the design and detailing of an entire wall system is the responsibility of a professional. These details will guide the design professional in the use of Master Wall® Products. Master Wall disclaims design, warranty or construction intent or responsibility. **Bold or Brand Name = Master Wall® Product.** ©2025 Master Wall Inc.®