



**Master Wall Inc.**  
*Building a Culture of Excellence*



We finish strong.

## System Detail

Cut Aesthetic grooves for CIFS® Wood Grain in the desired pattern and depth, minimum 3/4" (19 mm) insulation below groove

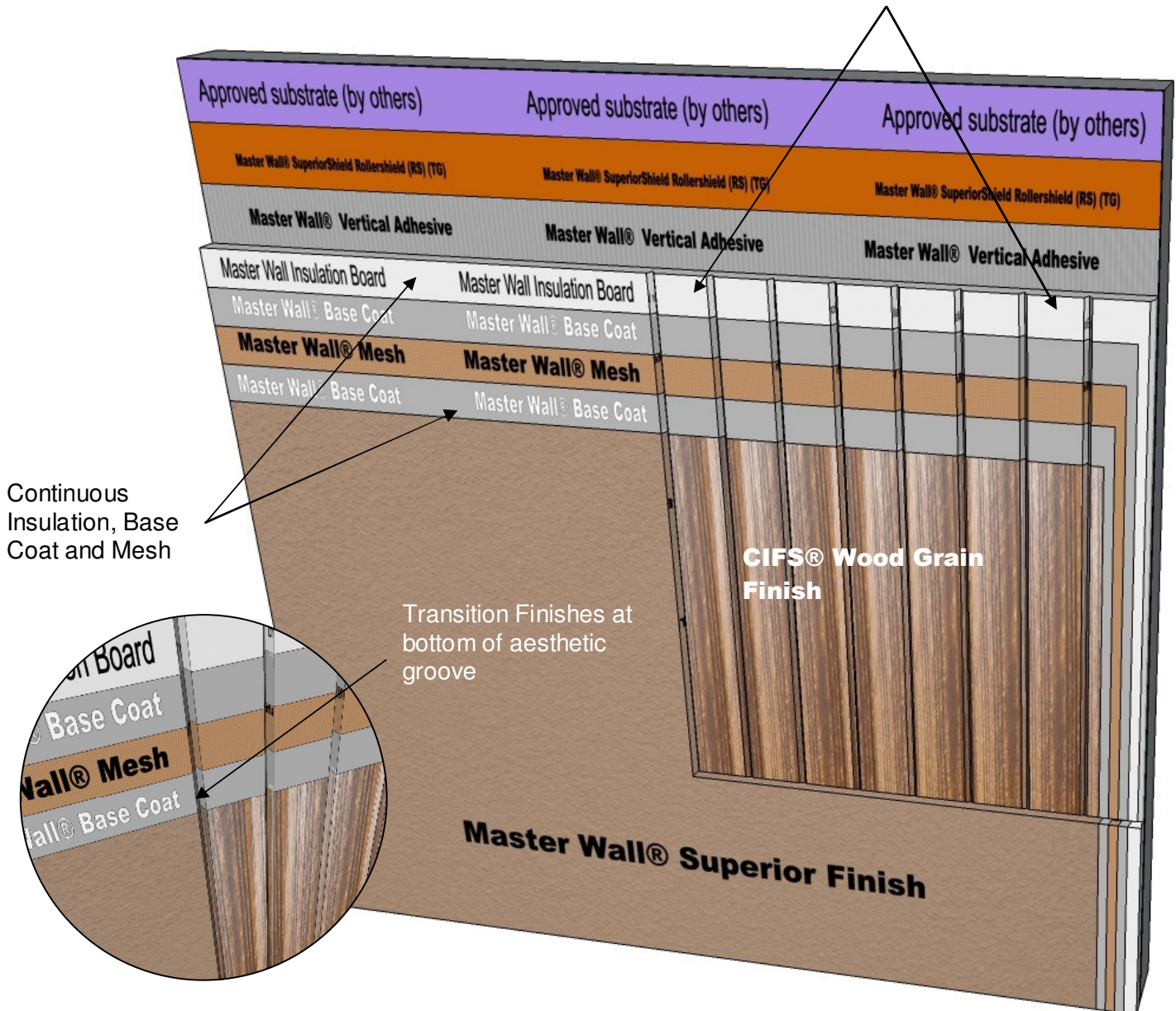

### RDCIFS SD 017 CIFS® WOOD GRAIN TRANSITION

These drawings relay the conceptual conditions of Master Wall® Systems and are not the construction drawings. Ultimately the design and detailing of an entire wall system is the responsibility of a professional. These details will guide the design professional in the use of Master Wall® Products. Master Wall disclaims design, warranty or construction intent or responsibility. **Bold = Master Wall® Product.**

©2019 Master Wall Inc.®