



**Master Wall Inc.**  
Building a Culture of Excellence



# Master Wall Systems

## Conceptual Details

Corporate • P.O. Box 397 • Fortson • Georgia • 31808 • 800-755-0825 • FAX 706-569-6704

Technical • 800-760-2861 • FAX 734-433-0930

### Rollershield Drainage CIFS®

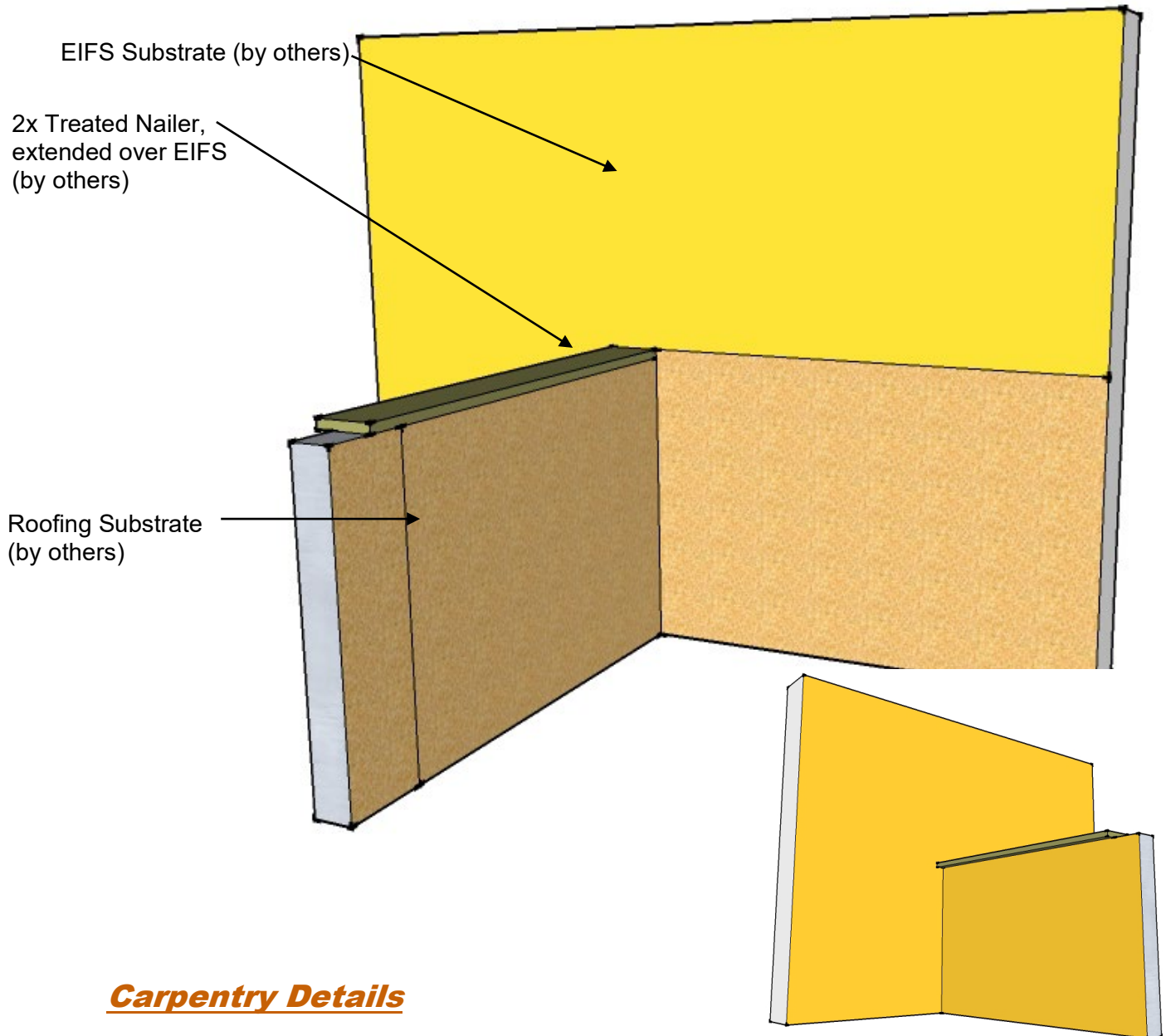

### Carpentry Details

## RDCIFS SD 022 CAP INTO WALL DETAILING

These drawings relay the conceptual conditions of Master Wall Systems and are not the construction drawings. Ultimately the design and detailing of an entire wall system is the responsibility of a professional. These details will guide the design professional in the use of Master Wall Products. Master Wall disclaims design, warranty or construction intent or responsibility.

©2011 Master Wall Inc.



**Master Wall Inc.**  
Building a Culture of Excellence



# Master Wall Systems

## Conceptual Details

Corporate • P.O. Box 397 • Fortson • Georgia • 31808 • 800-755-0825 • FAX 706-569-6704

Technical • 800-760-2861 • FAX 734-433-0930

### Rollershield Drainage CIFS®

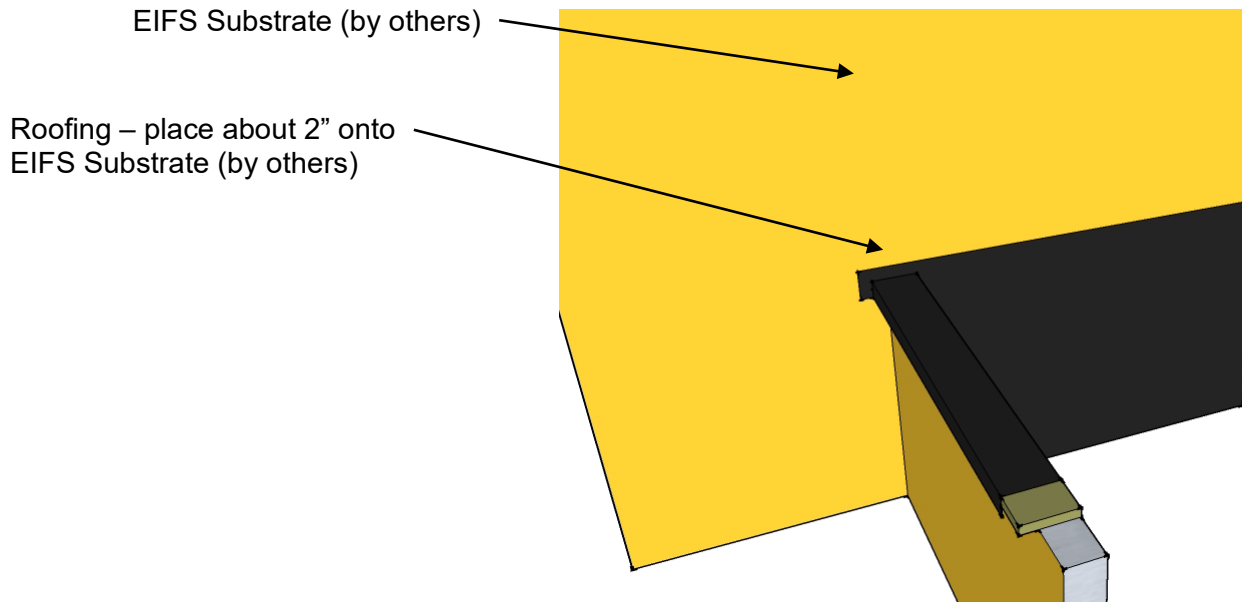

Flop roofing over nailer, temporary nail as necessary (by others)

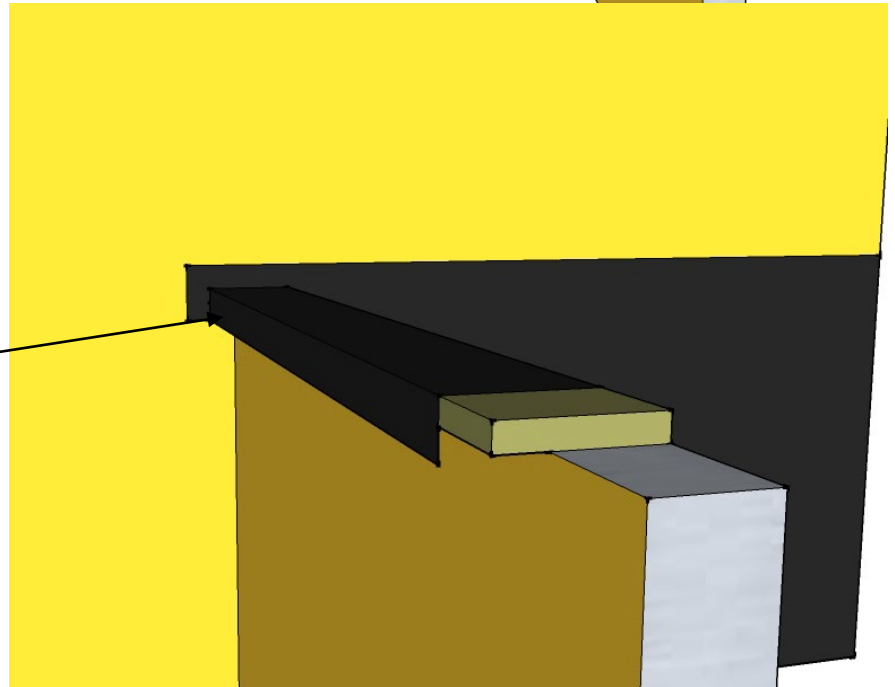

### Roofing Details

## RDCIFS SD 022 CAP INTO WALL DETAILING

These drawings relay the conceptual conditions of Master Wall Systems and are not the construction drawings. Ultimately the design and detailing of an entire wall system is the responsibility of a professional. These details will guide the design professional in the use of Master Wall Products. Master Wall disclaims design, warranty or construction intent or responsibility.

©2011 Master Wall Inc.



**Master Wall Inc.**  
Building a Culture of Excellence

# Master Wall Systems

## Conceptual Details

Corporate • P.O. Box 397 • Fortson • Georgia • 31808 • 800-755-0825 • FAX 706-569-6704

Technical • 800-760-2861 • FAX 734-433-0930



### Rollershield Drainage CIFS®

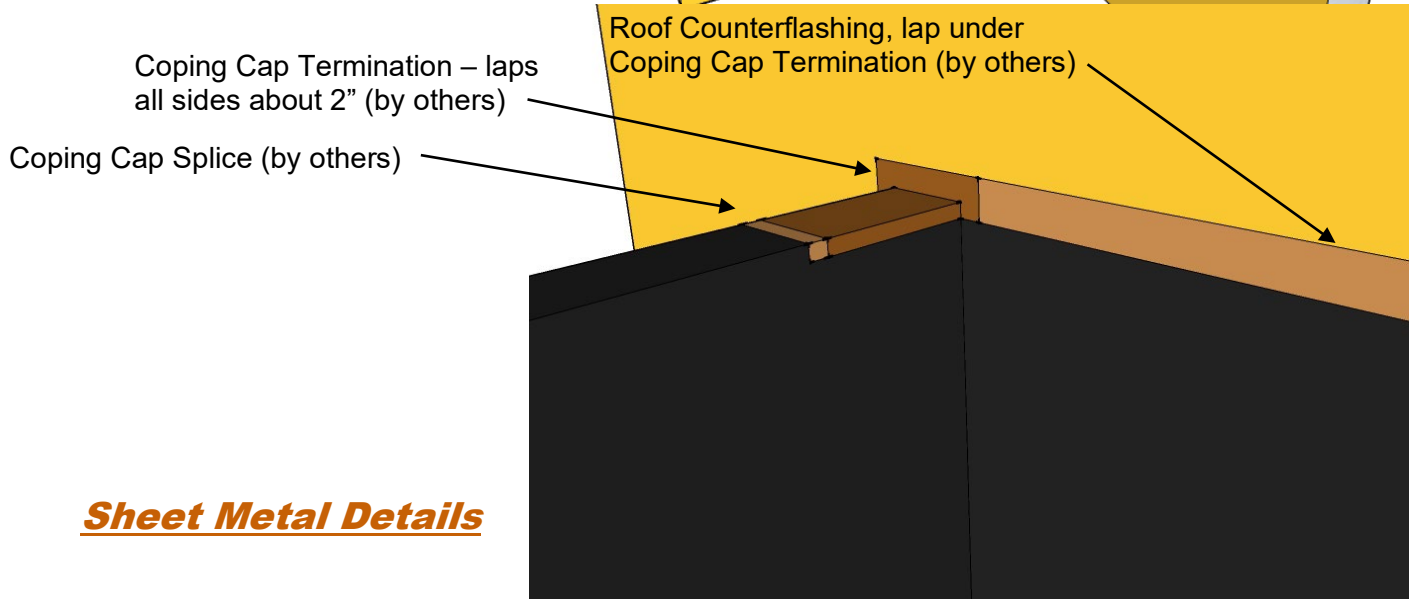
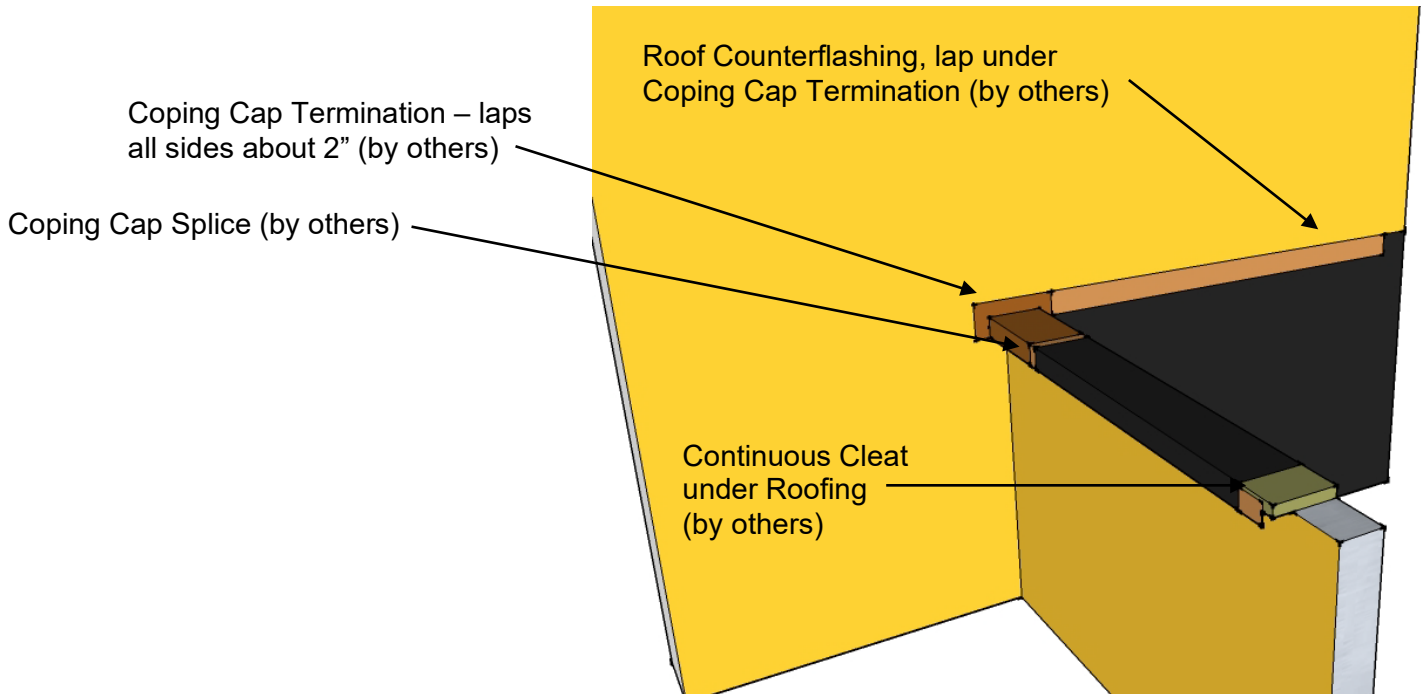

### Sheet Metal Details

These drawings relay the conceptual conditions of Master Wall Systems and are not the construction drawings. Ultimately the design and detailing of an entire wall system is the responsibility of a professional. These details will guide the design professional in the use of Master Wall Products. Master Wall disclaims design, warranty or construction intent or responsibility.

©2011 Master Wall Inc.



**Master Wall Inc.**  
Building a Culture of Excellence



# Master Wall Systems

*Conceptual Details*

Corporate • P.O. Box 397 • Fortson • Georgia • 31808 • 800-755-0825 • FAX 706-569-6704

Technical • 800-760-2861 • FAX 734-433-0930

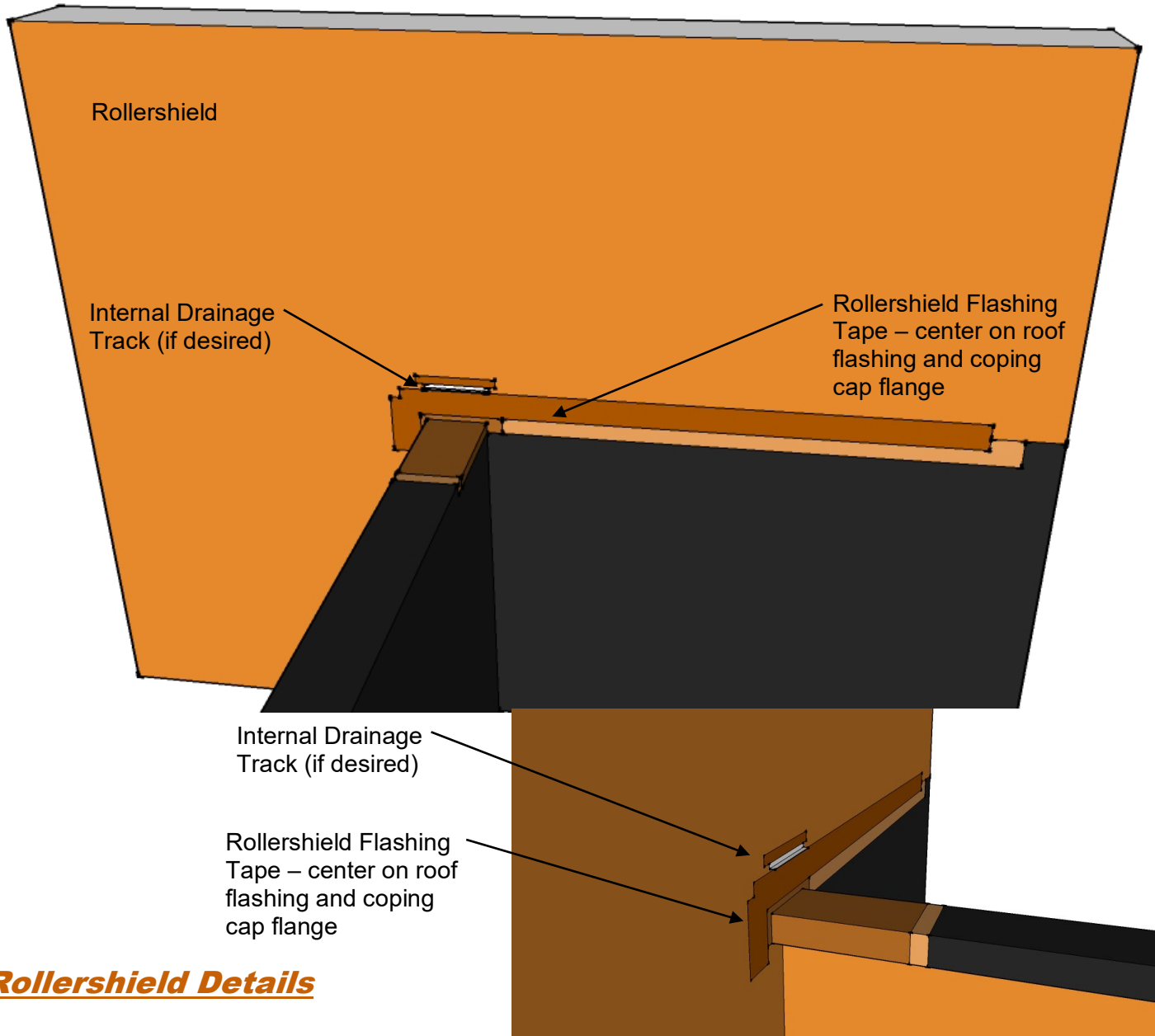

## Rollershield Details

## Rollershield EIFS System

### RDCIFS SD 022 CAP INTO WALL DETAILING

These drawings relay the conceptual conditions of Master Wall Systems and are not the construction drawings. Ultimately the design and detailing of an entire wall system is the responsibility of a professional. These details will guide the design professional in the use of Master Wall Products. Master Wall disclaims design, warranty or construction intent or responsibility.

©2011 Master Wall Inc.



# Master Wall Systems

## Conceptual Details

Corporate • P.O. Box 397 • Fortson • Georgia • 31808 • 800-755-0825 • FAX 706-569-6704  
 Technical • 800-760-2861 • FAX 734-433-0930

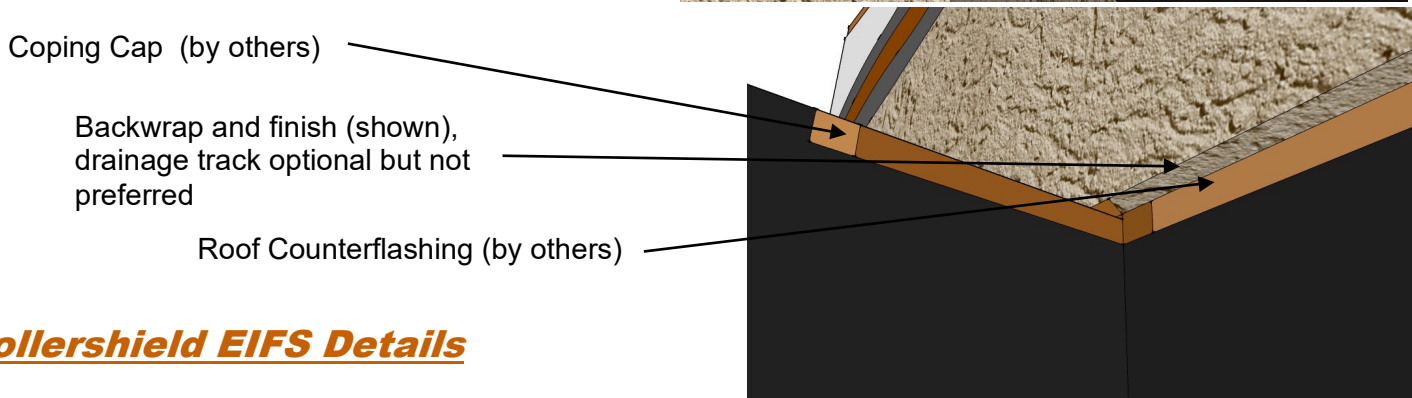
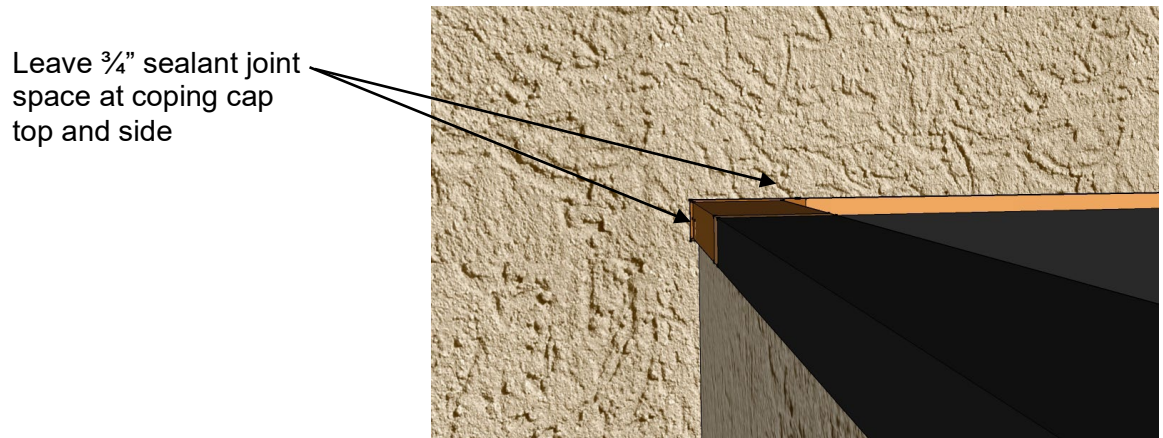
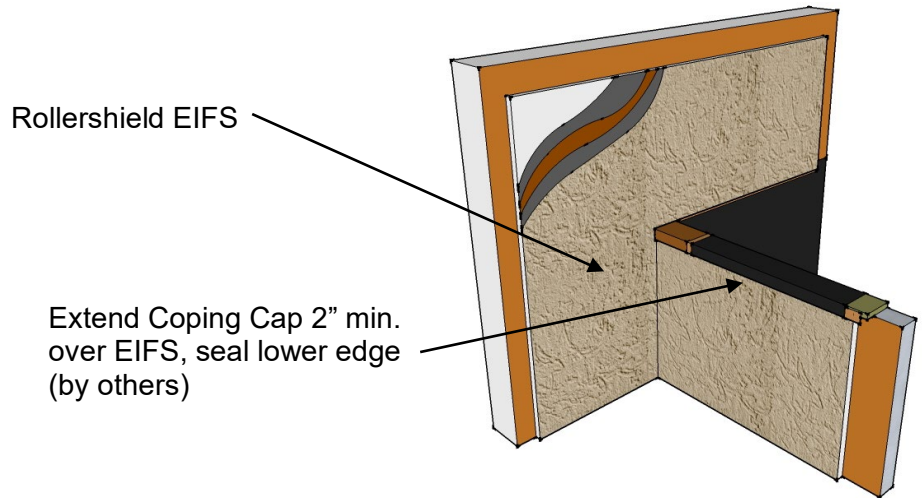

### Rollershield EIFS Details

These drawings relay the conceptual conditions of Master Wall Systems and are not the construction drawings. Ultimately the design and detailing of an entire wall system is the responsibility of a professional. These details will guide the design professional in the use of Master Wall Products. Master Wall disclaims design, warranty or construction intent or responsibility.





**Master Wall Inc.**  
Building a Culture of Excellence



# Master Wall Systems

## Conceptual Details

Corporate • P.O. Box 397 • Fortson • Georgia • 31808 • 800-755-0825 • FAX 706-569-6704

Technical • 800-760-2861 • FAX 734-433-0930

$\frac{3}{4}$ " Sealant Joint  
(by others)

Sealant Joint under  
face of coping cap  
(by others)

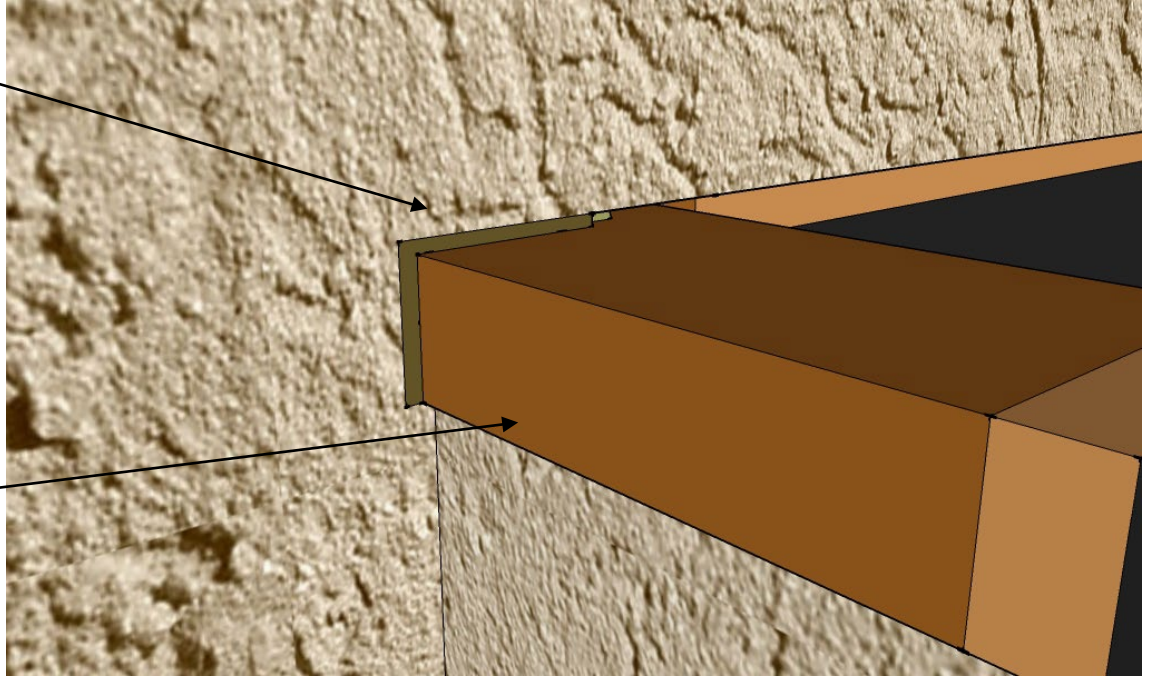

$\frac{3}{4}$ " sealant joint  
with backer rod  
(by others)

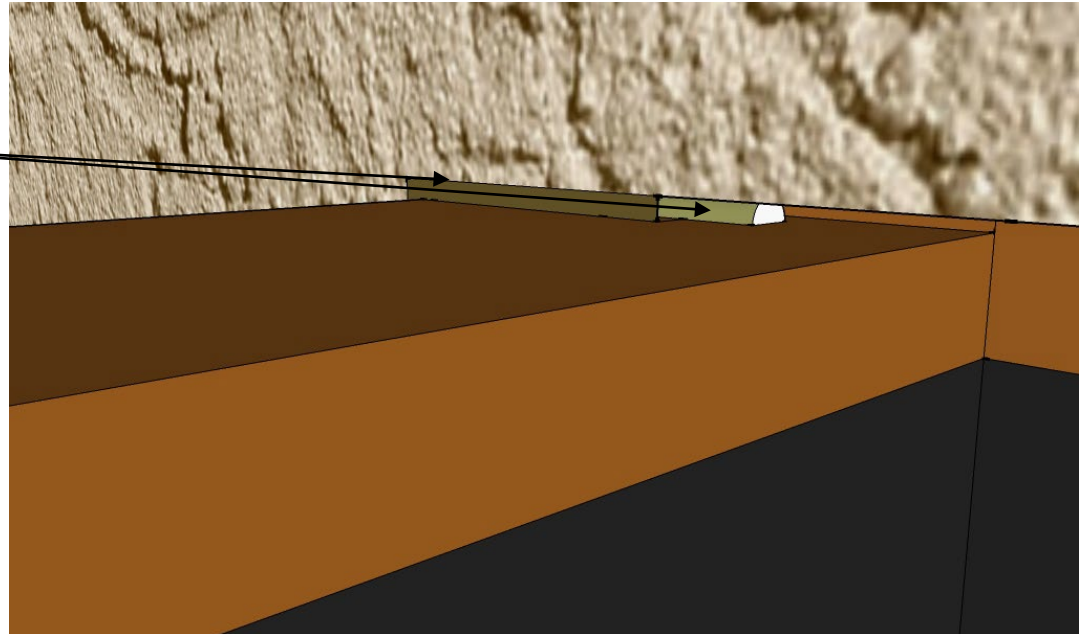

### Sealant Details

These drawings relay the conceptual conditions of Master Wall Systems and are not the construction drawings. Ultimately the design and detailing of an entire wall system is the responsibility of a professional. These details will guide the design professional in the use of Master Wall Products. Master Wall disclaims design, warranty or construction intent or responsibility.

©2011 Master Wall Inc.