

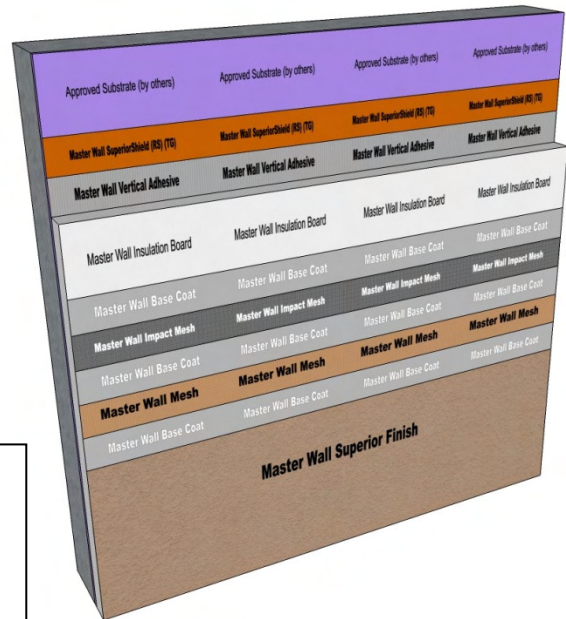

# Rollershield Drainage CIFS™ – Continuously Insulated Section 07 24 19



**Single Layer Mesh System**



**Double Layer Mesh System**

**Impact ASTM E2486 (Formerly EIMA 101.86)**

Standard Mesh	Medium Impact Resistance	50-89 in-lbs (5.7-10.1J)
Hi Tech Mesh	Medium Impact Resistance	50-89 in-lbs (5.7-10.1J)
Medium Mesh	Medium Impact Resistance	50-89 in-lbs (5.7-10.1J)
Medium & Standard	High Impact Resistance	90-150 in-lbs (10.2-17.0J)
Strong & Standard	Ultra High Impact Resistance	150+ in-lbs (over 17.0J)
Ultra & Standard	Ultra High Impact Resistance	150+ in-lbs (over 17.0J)

## **RDCIFS-01 STANDARD AND IMPACT CROSS SECTION**

Model Link: <https://3dwarehouse.sketchup.com/model/822f58a3-6dcf-45ef-93a9-523a19d1cd7b/RDCIFS-01-STANDARD-AND-IMPACT-CROSS-SECTION>

These drawings relay the conceptual conditions of Master Wall® Systems and are not the construction drawings. Ultimately the design and detailing of an entire wall system is the responsibility of a professional. These details will guide the design professional in the use of Master Wall® Products. Master Wall disclaims design, warranty or construction intent or responsibility. **Bold = Master Wall® Product.**

©2018 Master Wall Inc.®