

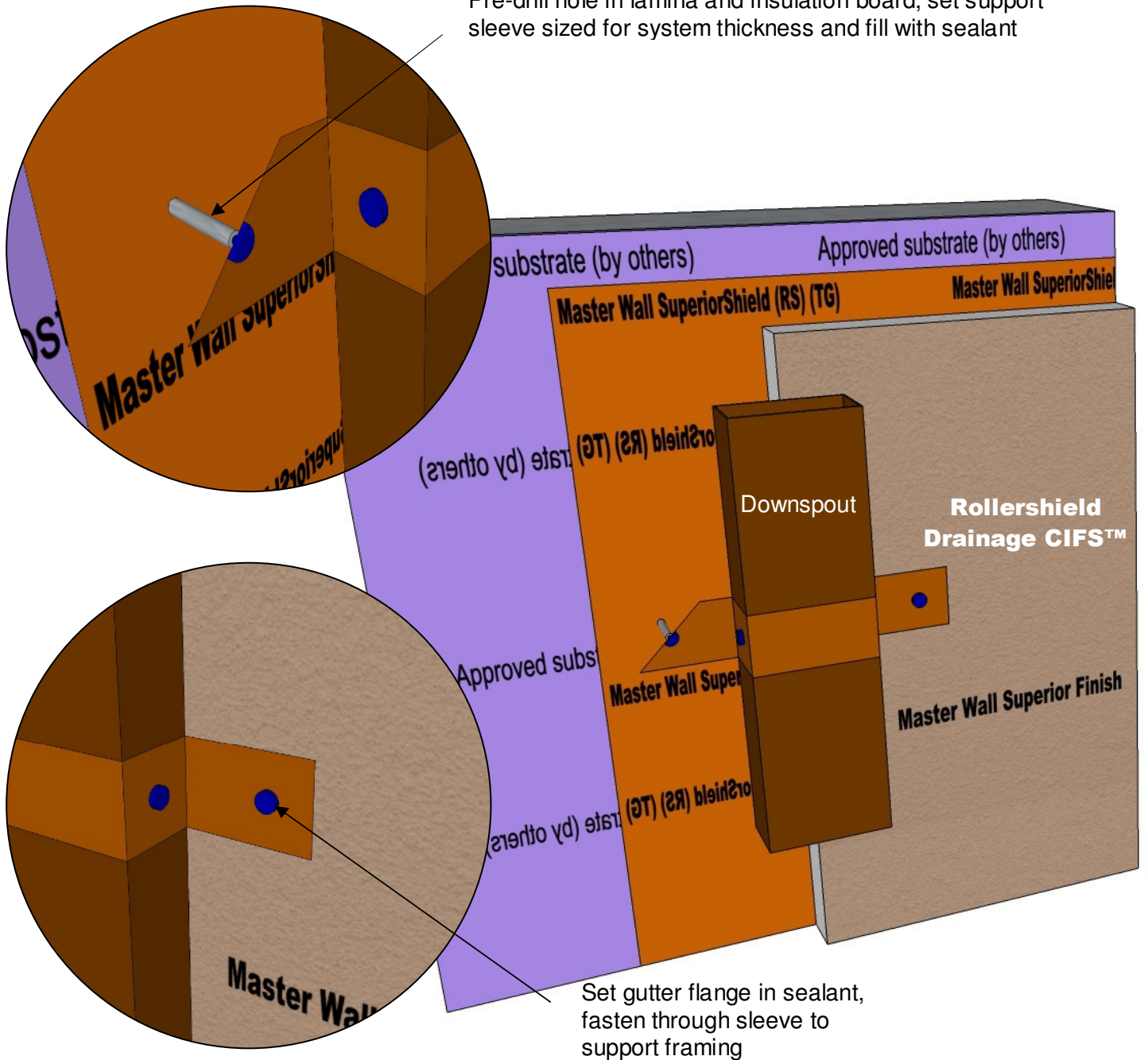

## Rollershield Drainage CIFS™ – Continuously Insulated Section 07 24 19

Pre-drill hole in lamina and insulation board, set support sleeve sized for system thickness and fill with sealant



### **RDCIFS-23 TYPICAL DOWNSPOUT ATTACHMENT**

Model Link: <https://3dwarehouse.sketchup.com/model/c06e4fdb-5c85-4729-9522-ee52694c9482/Rollershield-Drainage-CIFS%E2%84%A2-Downspout-Attachment>

*Note: EIFS is non-structural. Support loads must pass through to proper structural support*

These drawings relay the conceptual conditions of Master Wall® Systems and are not the construction drawings. Ultimately the design and detailing of an entire wall system is the responsibility of a professional. These details will guide the design professional in the use of Master Wall® Products. Master Wall disclaims design, warranty or construction intent or responsibility. **Bold = Master Wall® Product.**

©2018 Master Wall Inc.®