

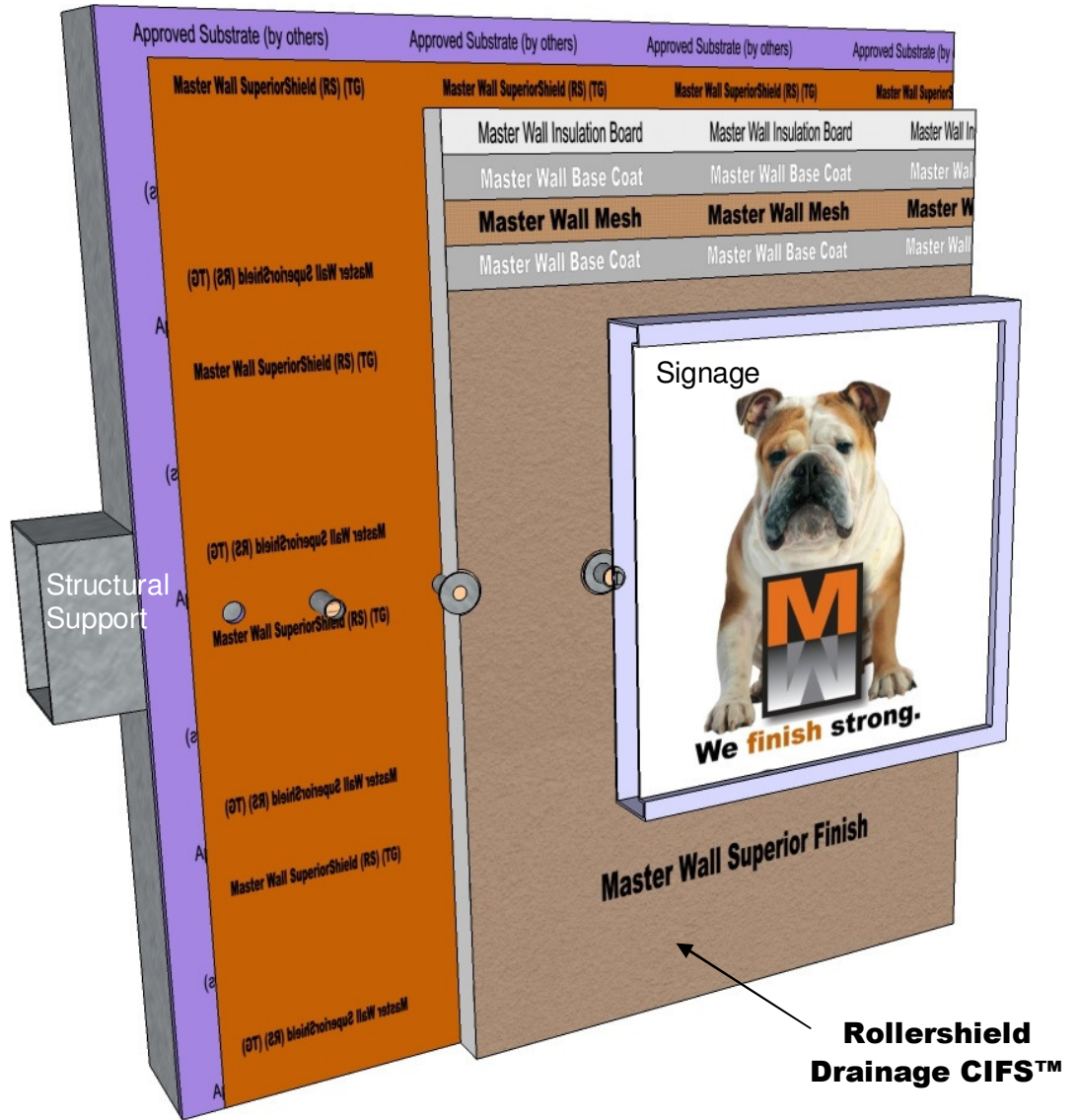

Rollershield Drainage CIFS™ – Continuously Insulated Section 07 24 19

Fastener Attachment

- A. Pre-drill hole the size of the structural sleeve through EIFS and substrate to structural support.
- B. Fill hole in sheathing with sealant. Insert structural sleeve sized for Sheathing, Insulation and Lamina thickness.
- C. Set oversize washer in sealant.
- D. Install a structural spacer to ventilate behind the signage (approximately 1" or 25 mm) and fasten signage to the structural support.

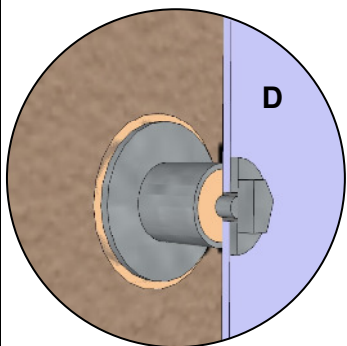
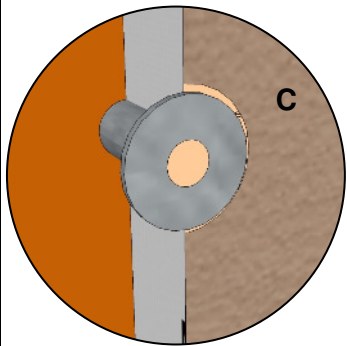
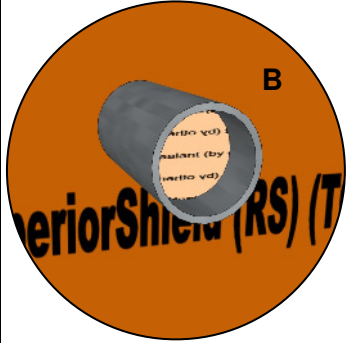
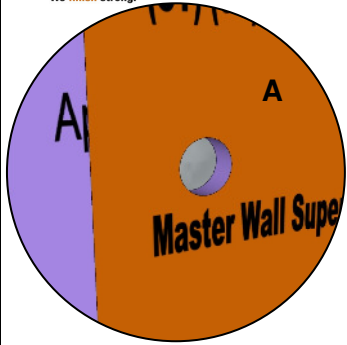

RDCIFS-24 TYPICAL SIGNAGE ATTACHMENT

Model Link: <https://3dwarehouse.sketchup.com/model/a018b5ca-c766-46b0-9d86-375d1e618318/Rollershield-Drainage-CIFS%E2%84%A2-Signage-Attachment>

Note: EIFS is non-structural. Support loads must pass through to proper structural support

These drawings relay the conceptual conditions of Master Wall® Systems and are not the construction drawings. Ultimately the design and detailing of an entire wall system is the responsibility of a professional. These details will guide the design professional in the use of Master Wall® Products. Master Wall disclaims design, warranty or construction intent or responsibility. **Bold = Master Wall® Product.**
©2018 Master Wall Inc.®