

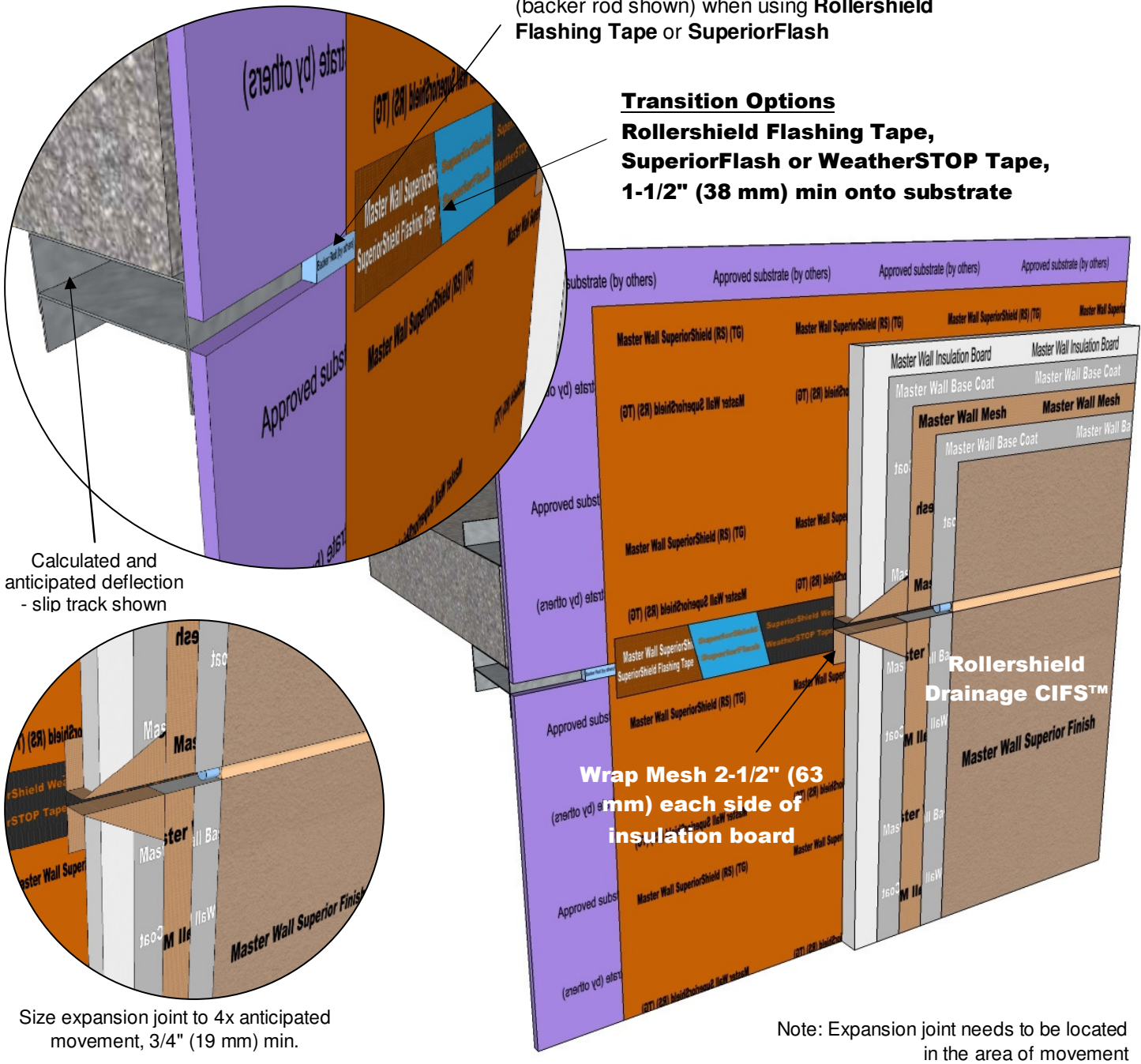

Rollershield Drainage CIFS™ – Continuously Insulated Section 07 24 19

Provide compressible fill at joint location
(backer rod shown) when using **Rollershield
Flashing Tape** or **SuperiorFlash**

Transition Options
Rollershield Flashing Tape,
SuperiorFlash or WeatherSTOP Tape,
1-1/2" (38 mm) min onto substrate



RDCIFS-30 HORIZONTAL EXPANSION JOINT - METAL FRAME

Model Link: <https://3dwarehouse.sketchup.com/model/c7cbf971-5aed-4556-a384-3e19c0a7f78e/Rollershield-Drainage-CIFS%E2%84%A2-Floor-Line-Expansion-Joint-with-Metal-Framing>

These drawings relay the conceptual conditions of Master Wall® Systems and are not the construction drawings. Ultimately the design and detailing of an entire wall system is the responsibility of a professional. These details will guide the design professional in the use of Master Wall® Products. Master Wall disclaims design, warranty or construction intent or responsibility. **Bold = Master Wall® Product.** ©2018 Master Wall Inc.®