

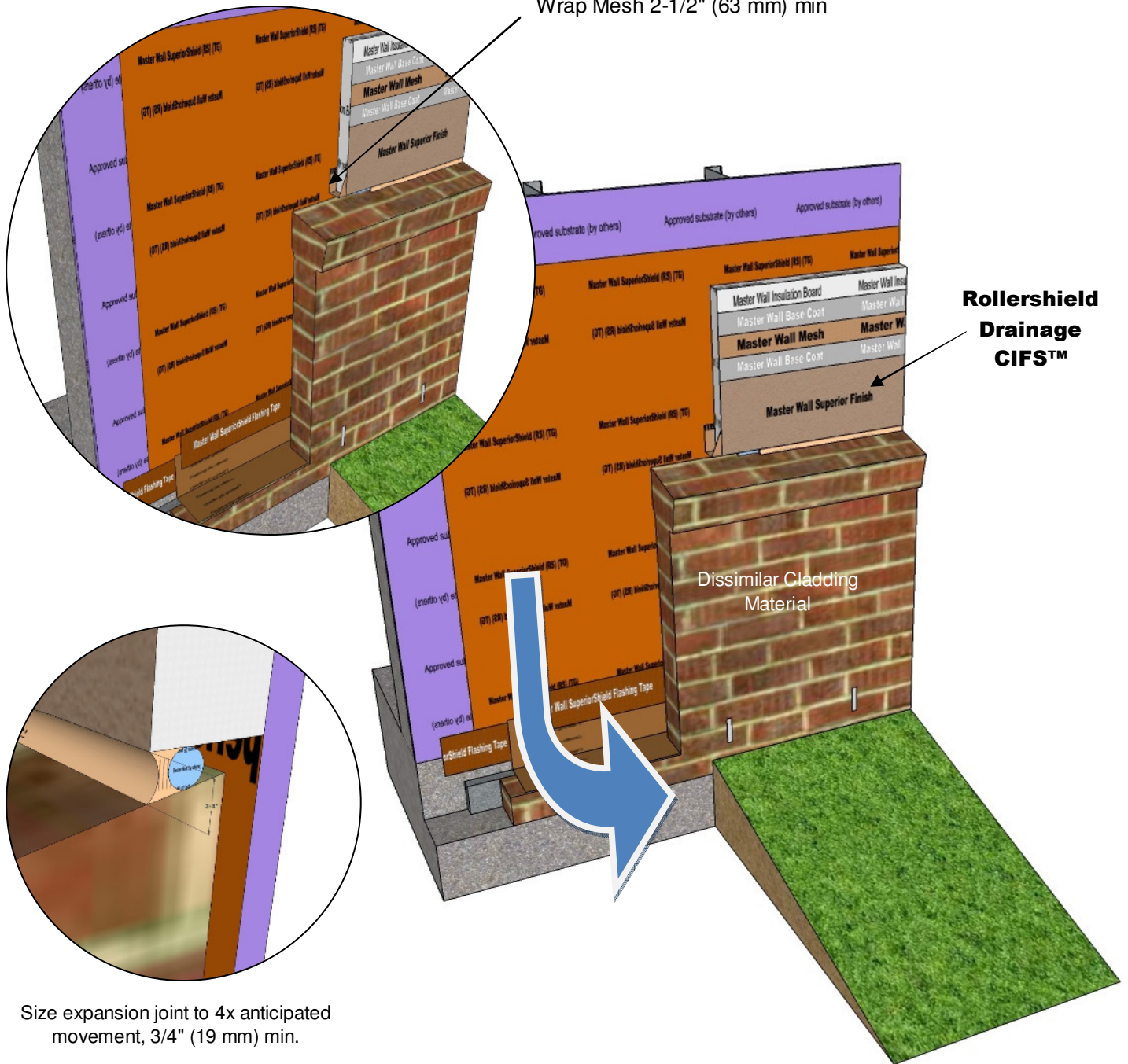

# Rollershield Drainage CIFS™ – Continuously Insulated Section 07 24 19

Wrap Mesh 2-1/2" (63 mm) min



Size expansion joint to 4x anticipated movement, 3/4" (19 mm) min.

## **RDCIFS-34 DISSIMILAR CLADDING TRANSITION CONTINUOUS WATER BARRIER**

Model Link: <https://3dwarehouse.sketchup.com/model/2f32cad2-883b-4333-a5ae-f038ddcb22e6/Rollershield-Drainage-CIFS%E2%84%A2-Detail-at-Material-Transition>

These drawings relay the conceptual conditions of Master Wall® Systems and are not the construction drawings. Ultimately the design and detailing of an entire wall system is the responsibility of a professional. These details will guide the design professional in the use of Master Wall® Products. Master Wall disclaims design, warranty or construction intent or responsibility. **Bold = Master Wall® Product.**

©2018 Master Wall Inc.®